

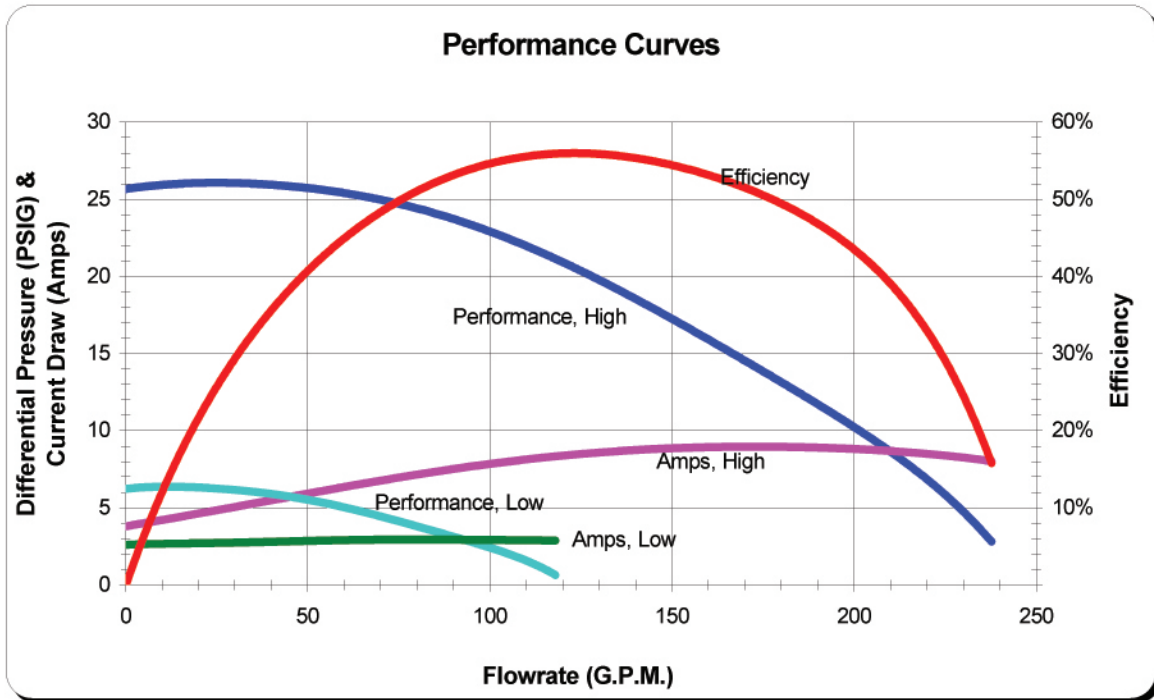

## Product Specification Sheet Model XP2E632022

Aqua-Flo's *energy conscience* offering, the XP2e, provides greater flow rates than the XP2 while improving the overall energy efficiency of the spa, reducing operating costs. The XP2e allows for the use of more jets per pump and in some applications, the elimination of the diverter valve.



These performance curves are a result of in-lab testing using 3" suction line, actual performance may vary based on manufacturing tolerances and application.

Performance Table						
PSI	2.8	10.2	17.3	22.8	25.7	25.7
GPM	237.7	200	150	100	50	0
<b>BEP</b>	<b>120 GPM</b>					

Motor Data					
<b>Manufacturer:</b>	Emerson	<b>AF Part Number:</b>	93526931	<b>Model:</b>	R63MWDLY-173
<b>HP:</b>	2.0	<b>FLA:</b>	9.0/3.2	<b>Volts:</b>	230
<b>Freq:</b>	60	<b>Phase:</b>	1	<b>Frame:</b>	56
				<b>RPM:</b>	3450/1725
				<b>Speed:</b>	2

Shipping Weight: 37.38 lbs    Pumps per pallet layer: 10

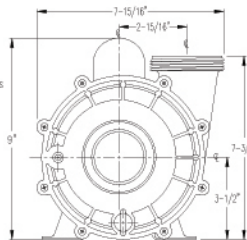
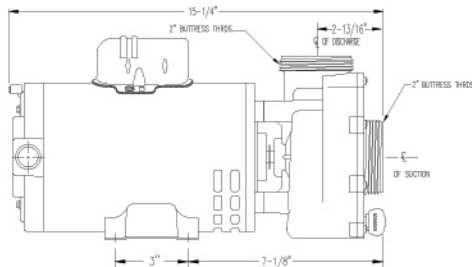

### Gecko Alliance - Pump Division

Maker of Aqua-Flo by Gecko Pumps for the Leisure Water Industry  
5651 Schaefer Avenue, Chino, California 91710-9048 USA, 909.591.7453, Fax: 909.627.5660  
www.geckoalliance.com

